



Curva de performance da bomba XFP 201J-CB2 60 HZ

Número da curva

Curva de referência
XFP 201J-CB2

			Bocal de descarga DN200	Frequência 60 Hz
Densidade 1000 kg/m ³	Viscosidade 0,0000169 ft ² /s	Normas de referência ISO 9906 Gr 1	Velocidade nominal 1185 rpm	Data 07.08.2013
Vazão 399 m ³ /h	Altura 9,93 m	Potência nominal 14,8 kW	Red. hidráulico 73 %	NPSH 2,9 m

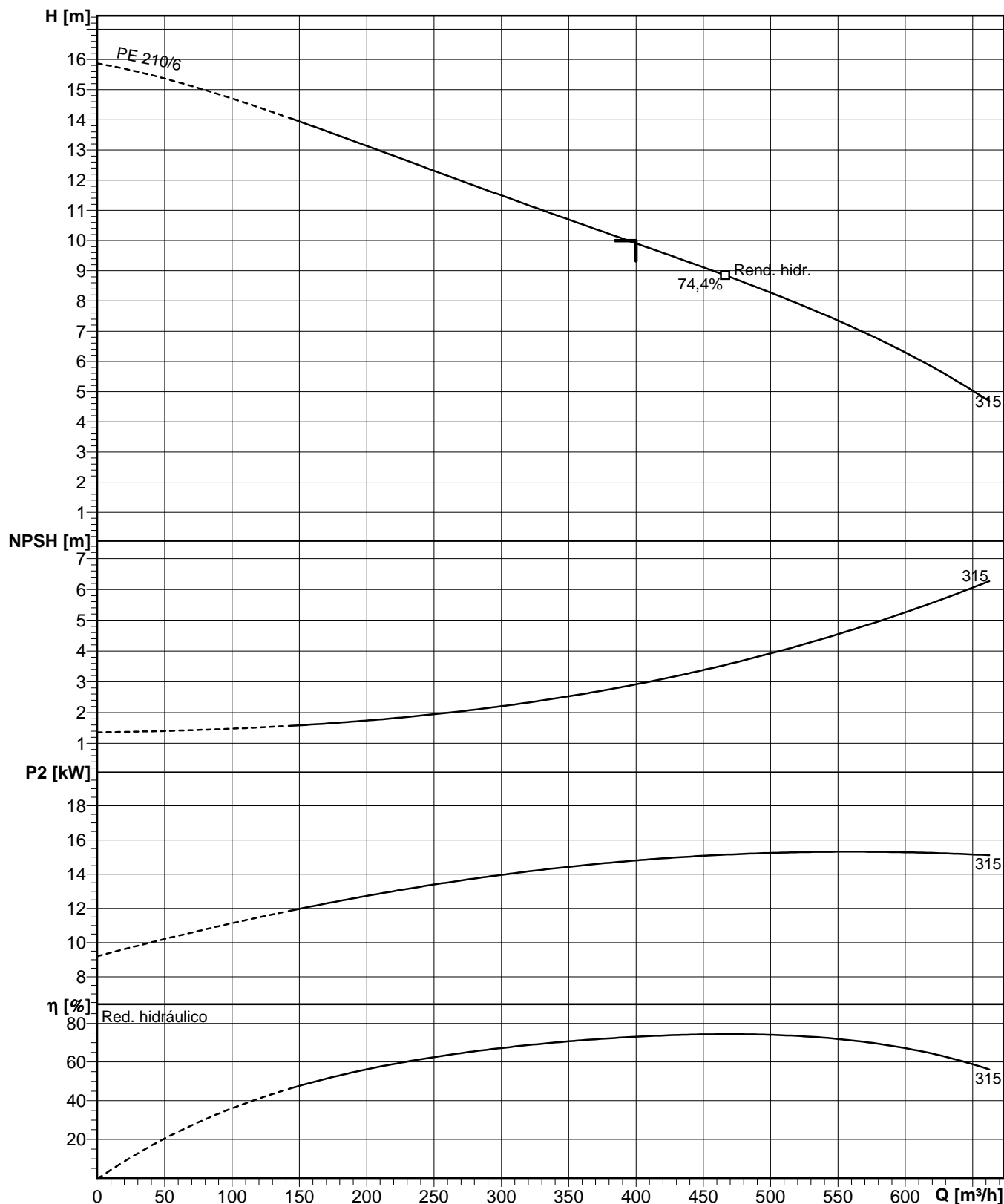

Diam. do propulsor 315 mm	N de aletas 2	Propulsor Propulsor contrabloc, 2 canais	Dim. de sólidos 100 mm	Revisão 2011-09-27
------------------------------	------------------	---	---------------------------	-----------------------

A ABS se reserva ao direito de mudar qualquer dado ou dimensão sem aviso prévio e não se responsabiliza pela utilização das informações contidas neste software.

ABSEL PRO 1.7.2 / 21.12.2006

XFP 201J-CB2 60 HZ

XFP PE4-PE6

Type: XFP 201J-CB2 60 HZ

ABS submersible pump, designed for reliable and economic pumping of heavily polluted sewage in commercial, industrial and municipal applications.

Driven by Premium Efficiency Motor (IE3 according to IEC 69934-30), exceeding Efficiency 1 according to CEMEP.

Motor insulation according to Class H, temperature rise according to Class A.

Water pressure-tight encapsulated fully flood-proof motor in explosion-proof versions.

Suitably cooled by surrounding medium for wet installation and with integrated closed cooling system for dry well installation.

Equipped with temperature and moisture sensors as standard.

Hydraulics with open or closed, multi-vane impellers suitable for handling of clear water, polluted water, sewage containing solids, faecal slurry and sludge.

Capacity up to m³/h
Head, max. m

Technical data

Delivery rate	: 399 m ³ /h
Delivery head	: 9,93 m
Hydr. efficiency	: 73 %
Shaft power	: 14,8 kW
NPSH	: 2,9 m
Speed	: 1185 rpm
Impeller type	: Propulsor contrabloc, 2 canais
Impeller diameter	: 315 mm
Motor output	: 21 kW
Voltage	: 220 V
Frequency	: 60 Hz
Discharge outlet	: DN200



Curvas do motor PE 210/6

Frequência
60 Hz

Potência nominal 21 kW	Fator de serviço	Velocidade nominal 1185 rpm	Numero de polos 6	Tensão nominal 220 V	Data 07.08.2013
---------------------------	------------------	--------------------------------	----------------------	-------------------------	--------------------

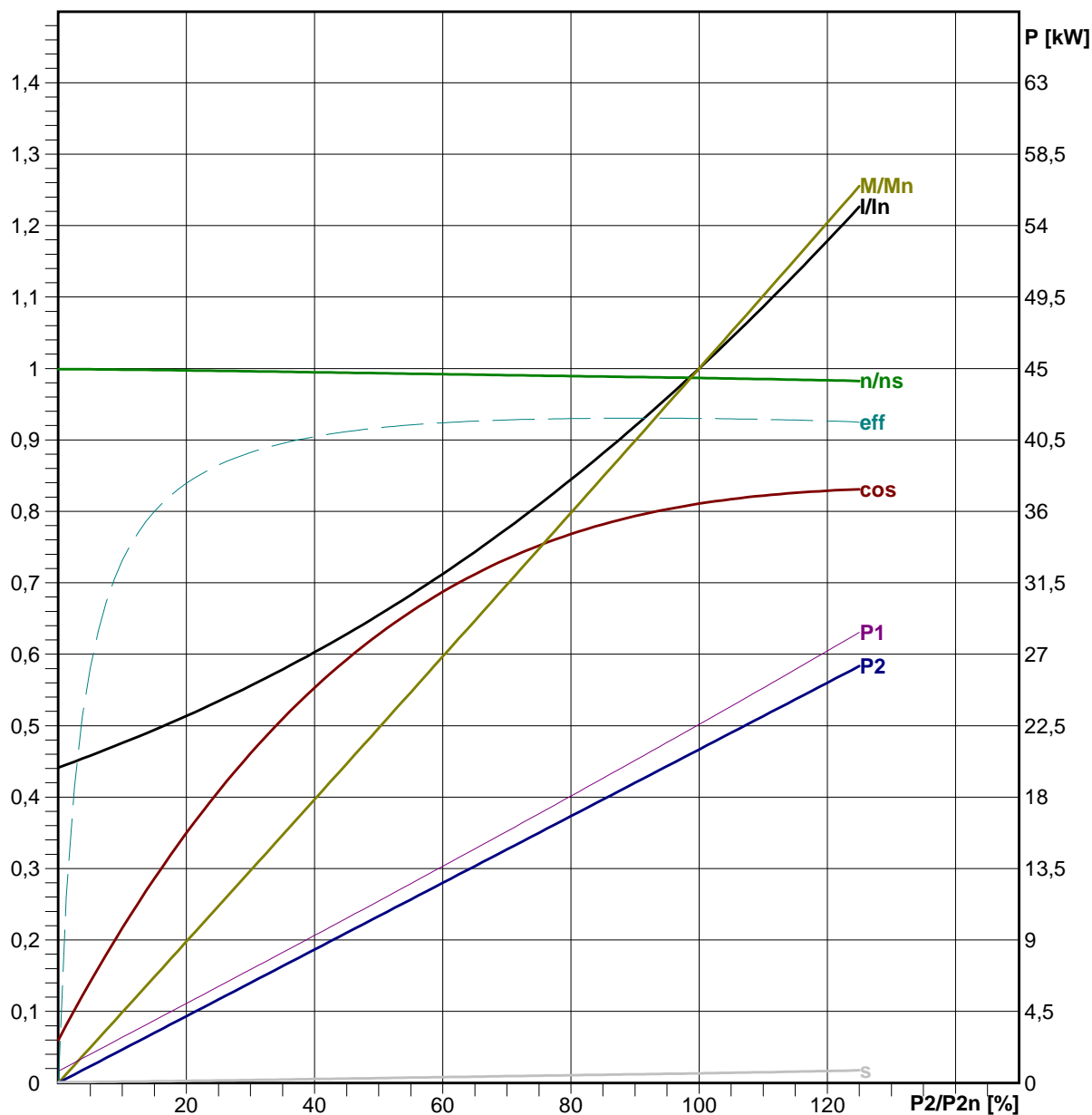

Carga	Vazio	25 %	50 %	75 %	100 %	125 %
P1 [kW]	0,7374	6,071	11,45	16,95	22,58	28,38
P2 [kW]	0	5,25	10,5	15,75	21	26,25
I [A]	32,26	39,04	47,86	59,15	73,09	89,63
eff [%]	0	86,48	91,69	92,91	93	92,48
cos	0,05999	0,4081	0,6279	0,7521	0,8107	0,831
n [rpm]	1199	1196	1192	1188	1184	1179
M [lbf ft]	0	30,92	62,04	93,38	124,9	156,8
s [%]	0,08333	0,3333	0,6667	1	1,333	1,75

Tolerâncias potência nominal segundo a VDE 0530 T1 12.84

Corrente de partida 482 A	Torque de partida 300 lbf ft	Momento de inércia 8,94 lb ft ²	
------------------------------	---------------------------------	---	--



XFP 201J-CB2

No: M-02.2554 - 00

Dat/Nam.: 02.07.2009 / H.Ramig

Dimension sheet PE4 WET WELL Installation

Cad Code: M_022554

Maßblatt PE4 Nassinstallation

Technical changes reserved

Änderungen vorbehalten

ABS se réserve le droit changer ses caracteristiques techniques

Plan d'encombrement PE4 installation submersible

Type Typ Tipo	Type Typ Tipo	Weight Gewicht Poids	Weight Gewicht Poids	H	H
50Hz	60Hz	(~kg)	(~lb)	(mm)	(inch)
PE 220/4-J	PE 250/4-J-60	530	1169	1413	55.6
PE 300/4-J	PE 350/4-J-60	555	1224	1493	58.8
PE 370/4-J	PE 430/4-J-60	585	1290	1413	55.6
PE 450/4-J	PE 520/4-J-60	605	1334	1493	58.8
	PE 210/6-J-60	525	1158	1413	55.6
	PE 250/6-J-60	555	1224	1493	58.8
	PE 350/6-J-60	590	1301	1493	58.8
	PE 430/6-J-60	601	1169		

Weight: Includes pump and slider bracket
 Gewicht: Beinhaltet Pumpe und Halterung
 Poids: Pompe et Coulisseau

For hex.-woodscrew 0,4*2,8 plug 0,5 DIA
 Für Skt.-Holzschr. 10*70 Dübel Ø12mm
 Pour vis à bois hexagonale 10*70 trou de 12mm

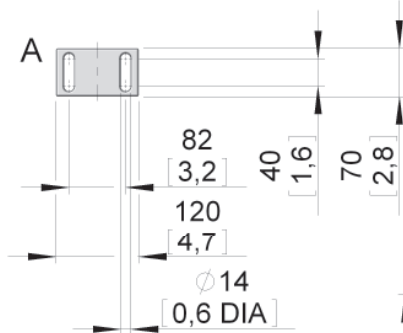

Lifting hoop cross section
 Fangbügel-Querschnitt
 Section d'étrier de sûreté

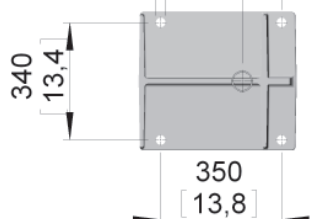
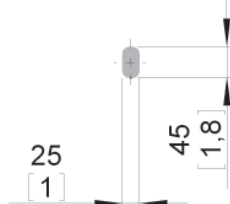

Installation Instructions "pedestal" 1 597 0725
 Installationsanweisung "Fußstück" 1 597 0725
 Instruction d'installation "socle" 1 597 0725

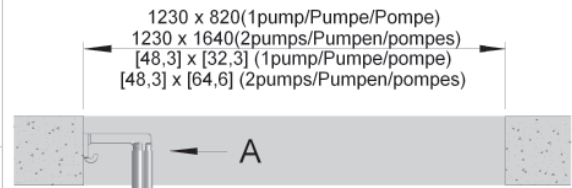

min. Sump opening
 min. Schachtoffnung
 Largeur min. du puisard

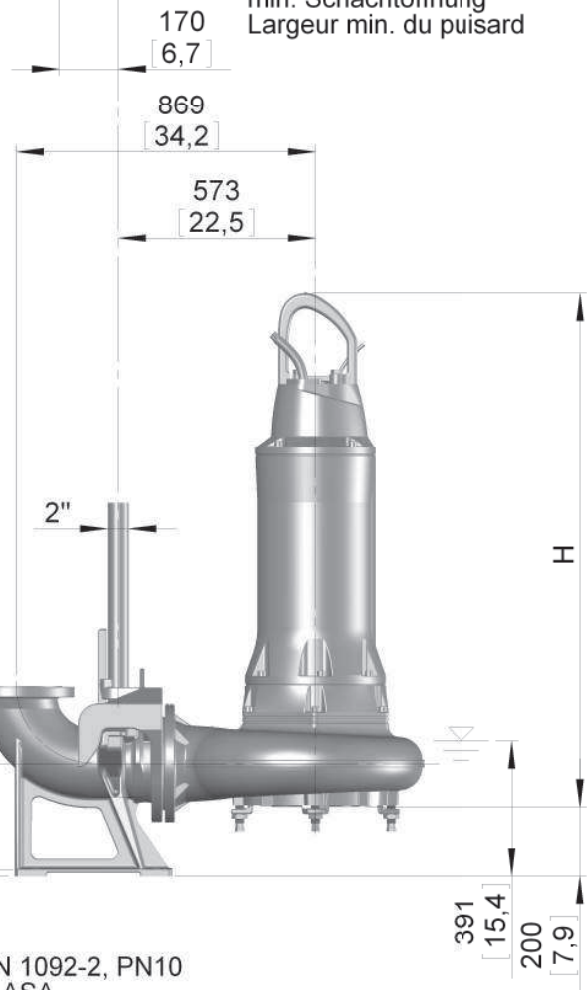

DN200, DIN EN 1092-2, PN10
 8" CLASS 125 ASA

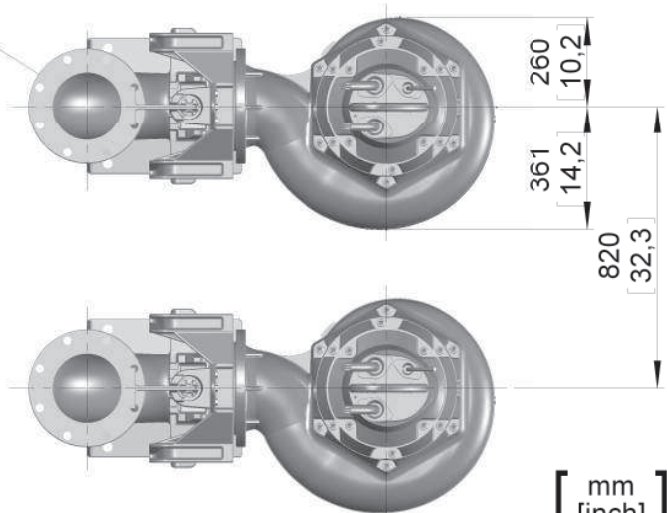

[mm]
 [inch]